

## EJOT® H3

Universal hammer-in anchor with plastic injection element, flexible washer and European Technical Assessment

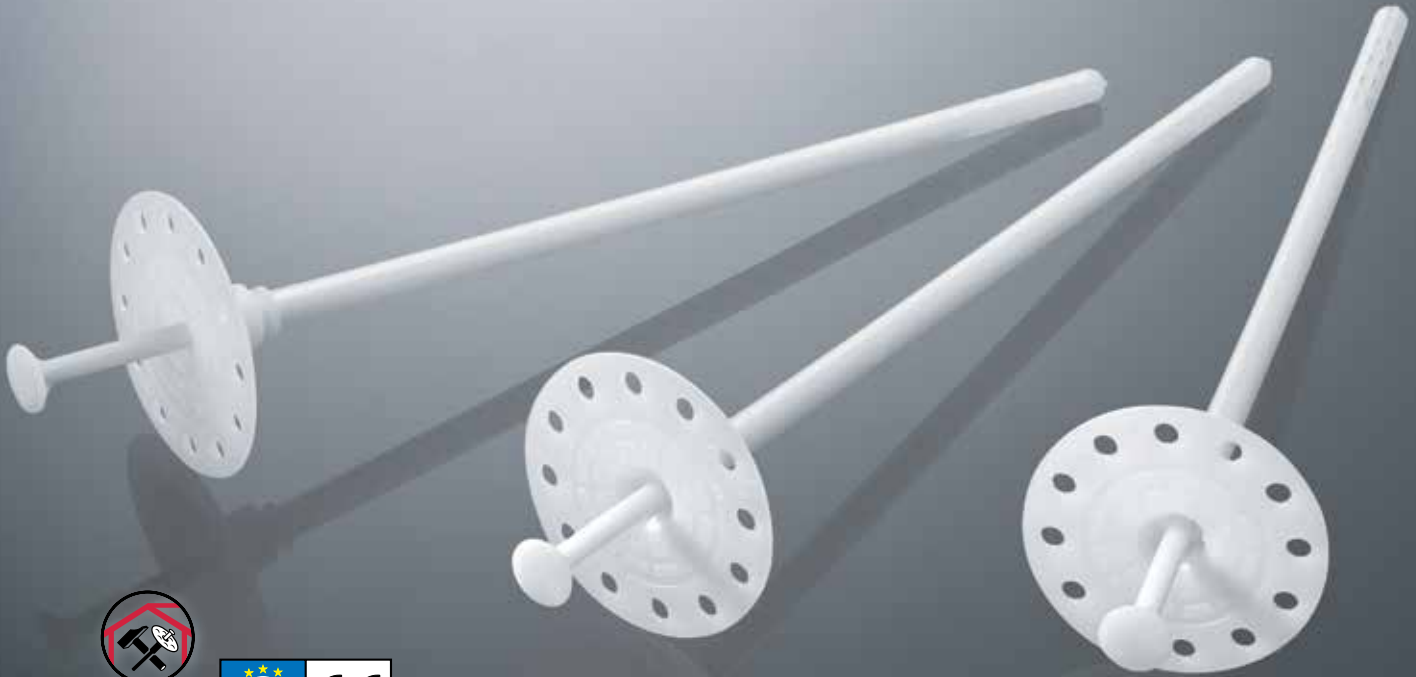

Fastening of insulation boards



### Installation

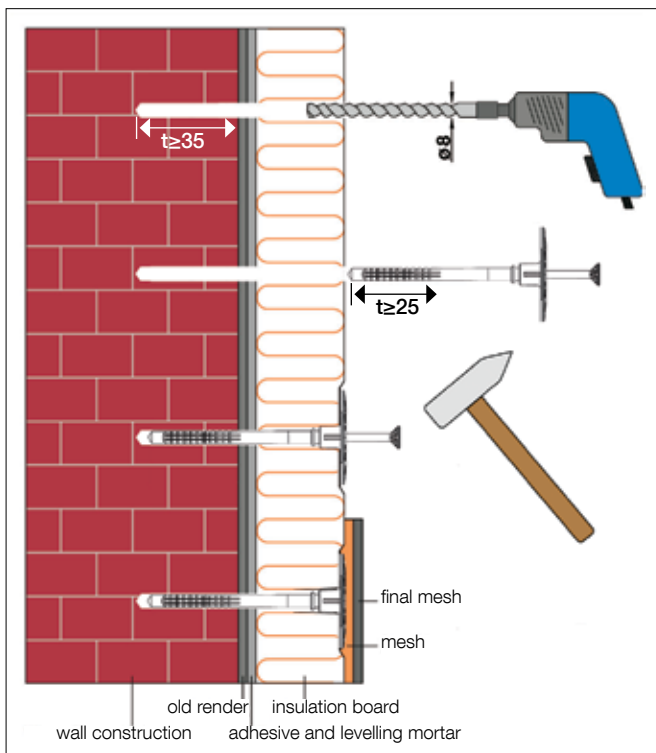

### Advantages

- ❑ Approved for concrete, solid and perforated masonry
- ❑ Precise installation due to defined anchor washer movement through movable washer
- ❑ The flexible anchor washer assures an optimum positioning in the insulation board, also in case of slightly sloped drilled boreholes
- ❑ Plastic injection element to reduce thermal transmission
- ❑ Short embedment depths, minimum drill hole depth
- ❑ Minimised risk of breaking nails due to fibre-reinforced composites
- ❑ Can be used with an additional spreader washer
- ❑ Premounted nail for quick installation

## EJOT® H3

Universal hammer-in anchor with plastic injection element, flexible washer and European Technical Assessment

Fastening of insulation boards

### Technical data

Anchor diameter	8 mm
Washer diameter	60 mm
Drill hole depth $h_1 \geq$	35 mm
Embedment depth $h_{ef} \geq$	25 mm
Point thermal transmission $\chi$	0.000 W/K
Use categories acc. to ETA	A, B, C
European Technical Assessment	ETA-14/0130

### Characteristic loads

A	Normal weight concrete C 20/25 acc. to EN 206-1	0.6 kN
A	Normal weight concrete C 50/60 acc. to EN 206-1	0.6 kN
B	Clay bricks (Mz) acc. to DIN 105	0.6 kN
B	Solid lime sandstone (KS) acc. to DIN EN 106	0.6 kN
C	Vertically perforated clay bricks (Hlz) acc. to DIN, bulk density, $\geq 1.2 \text{ kg/dm}^3$	0.6 kN
C	Vertically perforated clay bricks (Hlz) acc. to DIN, bulk density, $\geq 0.8 \text{ kg/dm}^3$	0.5 kN
C	Sand-lime perforated bricks (KSL) acc. to DIN EN 106	0.6 kN

Please note: For calculation of design loads the national safety factors have to be included (e.g. Germany: 3). Please observe the approval.

### Note: Flexible washer placement

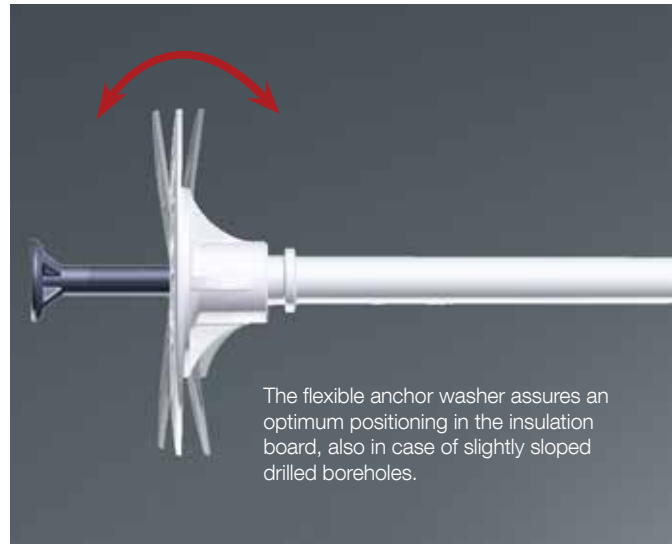

### Accessories

A broad range of accessories is available for the EJOT H3 product group:

EJOT combi washer VT 90 and SBL 140 plus



### Product range

Insulation (mm)		Product name and length (mm)	Product code	Packaging (pieces)	Pallet unit (pieces)
New build. <sup>1)</sup>	Renovation <sup>2)</sup>				
40	-	EJOT H3 075	8573 075 100	200	6,000
60	40	EJOT H3 095	8573 095 100	200	6,000
80	60	EJOT H3 115	8573 115 100	200	5,400
100	80	EJOT H3 135	8573 135 100	200	5,400
120	100	EJOT H3 155	8573 155 100	200	3,600
140	120	EJOT H3 175	8573 175 100	100	3,000
160	140	EJOT H3 195	8573 195 100	100	2,000
180	160	EJOT H3 215	8573 215 100	100	2,000
200	180	EJOT H3 235	8573 235 100	100	2,000

<sup>1)</sup> 10 mm adhesive

<sup>2)</sup> 10 mm adhesive and 20 mm old render